

WIRELESS RAIN GAUGE WITH TEMPERATURE

Instruction Manual

Function:

- Detail display of rainfall data in 1hour, 24hour, week and total since last reset(user selectable in inch or mm)
- Radio controlled time and date with manual setting option
- Calendar (day-month-year display)
- Indoor temperature (°C or °F)
- Time zone setting
- 12 or 24 hour time mode
- Wall hanging and Free standing

Specification

- Indoor temperature range: -10°C to +60°C
- Temperature accuracy: +/-1.0°C
- Rainfall display range: 0 to 19,999mm
- Power requirement:
 - a) Receiver: 2 x "AA" alkaline batteries (not included)
 - b) Rain gauge: 2 x "AAA" alkaline batteries (not included)
- Battery life: Minimum 24 months(1300mAH battery used).
- Transmission range: up to 100m (300 feet)
- Transmission frequency: 433MHz

Display Mode

While in normal mode, press the **SET** key to select time or calendar display. Calendar date display mode will be switched to time display after 10s when no key pressed.

Setting Mode

While in normal mode, press the **SET** key for 2 seconds to enter the following setting modes in the following order :

1. Time Zone Setting
2. 12/24 hour format
3. Manual time setting (hours/minutes)
4. Calendar setting(in the order of year /month/ date)
5. Temperature display unit degree Celsius or Fahrenheit

In the setting modes, press **RAIN** key to select the units or scrolls the value. Holding the **RAIN** key for 2 second will increase digits in great

steps. Press the **SET** key to accept the change and advance to the next setting mode. Continue to press the **SET** key to toggle through the setting mode until return to the normal Mode

RAIN Mode

While in normal mode, press **RAIN** key, 1hour rainfall record will be displayed. Press **RAIN** key again, 24hour rainfall record will be displayed. Press **RAIN** key the third time, week rainfall record will be displayed. Press Rain Key the fourth time, TOTAL rainfall record will be displayed.

Reset Rain Data

Press **RAIN** key for approx 2 seconds at 1hour rainfall mode, 1hour rainfall record will be reset to 0. Press **RAIN** key for approx 2 seconds at 24hour rainfall mode, 1hour and 24hour rainfall record will be reset to 0 . Press **RAIN** key for approx 2 seconds at week rainfall mode, 1hour, 24hour and week rainfall record will be reset to 0. Press **RAIN** key for approx 2 seconds at TOTAL rainfall mode, 1hour, 24hour, week and TOTAL rainfall record will be reset to 0

If longer than 10s no key operation, the unit will switch itself to normal display mode automatically.

Quick Set up

Note: Use good quality Alkaline Batteries; avoid rechargeable batteries.

1. Battery install

Place the batteries into the rain gauge first and next into the receiver.

Rain Gauge battery install

- 1) Remove Rain Gauge cover

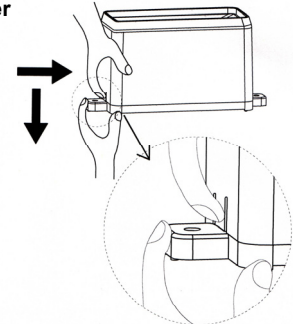

2) Remove the battery cover

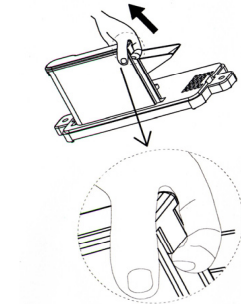

3) Observing the correct polarization insert 2 “AAA” Alkaline Batteries into the compartment and replace the cover.

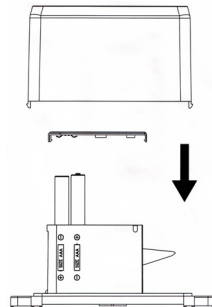

Note: When opening the battery cover make sure that the batteries do not spring free from the contacts since this will cause start and transmission problem.

- 2. Do not press any buttons before indoor receiver display the data from rain gauge.**
3. Place the rain gauge in an appropriate location. The rain gauge has a range of 100meters. Keep in mind that the 100 meters is in open air with no obstructions, rain gauge transmitter sitting one meter

above ground. Real-world transmission range will vary depending on what is in the path of the signal. Each obstruction (roof, walls, floors, ceilings, thick trees, etc.) will effectively cut signal range.

The rain gauge must be level to transmit correct readings. It is recommended to mount the rain gauge 1meter or higher off of the ground. Screw the rain gauge down snugly in the holes provided.